

## Unboxing & using your Helios Fire Pit

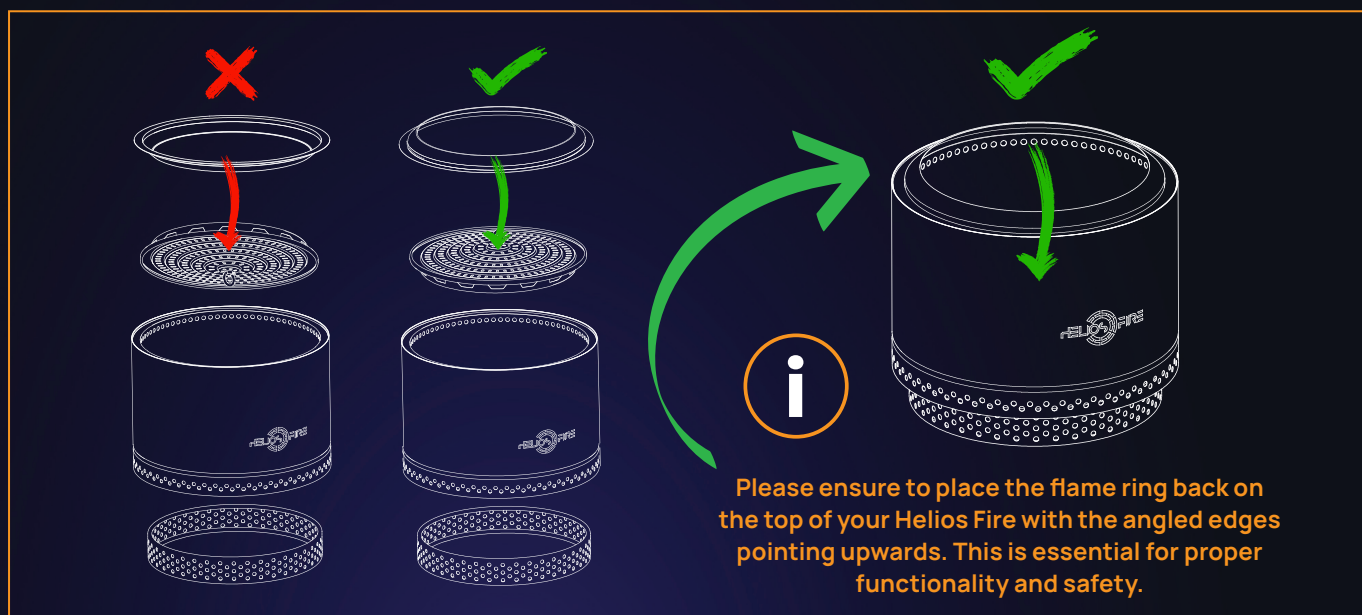

1 Unwrap your Helios Fire Pit. Remove the flame ring and set it aside.



2 Remove all packaging and items inside the Helios Fire, including the usage instructions, cover and ash pan.



3 First, place your stand on the ground where you will set up the Helios Fire. Then position the ash pan inside the Helios Fire, and you're all set.



4 Start building your fire by placing lots of kindling and small wood pieces in the centre of the Helios Fire, then ignite your fire.



5 Refer to diagram above, note the importance of this step.



6 As the fire gets hotter, go ahead and add 1-3 pieces of wood. Once those catch fire, add enough wood to fill the burn chamber. Happy burning! When you are ready to call it a night, let the fire burn out on its own.

## Caring for your Helios Fire correctly will maintain it's look and prolong the usability.

### Ash Removal

- In order to maintain optimal airflow and smokeless flames, empty your ash pan after each use.
- When your Helios Fire has completely cooled, remove your ash pan and tilt it on its side to allow the ash to fall through the holes on the sides of the ashtray.
- Once you've cleaned out and replaced the ash pan, your Helios Fire is ready for use.

### Storage

Keeping it covered under a roof is a good idea to protect it from the elements. You can purchase an all-weather cover for your Helios fire on the website: [www.heliosfire.com](http://www.heliosfire.com)

If you anticipate particularly harsh weather, bringing it indoors will help prevent any potential damage. Just make sure it's completely cool and dry before storing it!

### Surface Cleaning

Regularly check the stainless-steel surface for any signs of stains or rust. If needed, use a stainless-steel cleaner to maintain the firepit's appearance,



## Rings of Fire

While using the Helios Fire, you may notice some colour changes as a result of high temperatures.

Don't worry, this is completely normal. Over time, you might even see beautiful bronze and blue tints developing, which is a natural and lovely occurrence.

## Firewood

To get the best results, we recommend using dried and split hardwoods. Blue Gum and Namibian Dry Wood are both excellent options. Just a heads up, overfilling your Helios Fire above the upper vents will make it less efficient and produce more smoke.



# User WARNINGS

**Note: Helios Fire is for Outdoor use ONLY!**

- Do not use Helios Fire until you have read the operating instructions and safety warnings. Serious injury, death, or property damage may occur from improper use.
- Always use Helios Fire in accordance with all applicable local and national fire codes. Contact local authorities to ensure the firepit complies with regulations for outdoor recreational fires.
- Never leave Helios Fire unattended while lit, especially when children or pets are nearby, or when used on or near combustible surfaces.
- Do not alter or modify Helios Fire in any way. Doing so can result in serious injury, death, or damage to property.
- Always use Helios Fire on a level, surface to prevent risk of tipping over.
- Always use in conjunction with the provided ring base. The ring base ensures that your floors, whether combustible or not are protected from the heat.
- This is particularly important in the case of wood or composite decking or grass.
- Do not allow flammable liquids, fuel, or ignitable material to contact the Helios Fire during use. Fuel spillage or mishandling can lead to uncontrolled fires and severe burns.
- The Helios Fire becomes extremely hot during use. Never touch or attempt to move the firepit during use or until it has completely cooled.
- Do not use the Helios Fire during extremely windy conditions.
- The use of alcohol, prescription, or non-prescription drugs may impair your ability to safely operate the Helios Fire.
- Always dispose of as properly after use. It can be emptied into a metal container with a sealed lid (as the ashes may remain hot for several hours).
- Do not throw logs or heavy objects into the Helios Fire, as this may damage the structure or baseplate.
- Allow the Helios Fire to cool completely before moving or cleaning it.

### After Sales Service

For any concerns, contact our customer service team at [www.heliosfire.com](http://www.heliosfire.com)

**We're here to help!**

Enjoy your Heliosfire firepit, and please follow all safety guidelines.



**CAPE TOWN**

12 Milner Street, Paarden Eiland



**+27 21 300 7299**

[sales@heliosfire.com](mailto:sales@heliosfire.com)

[www.heliosfire.com](http://www.heliosfire.com)

